



1.25" Green Drain™

Waterless Trap Seal for Floor Drains

MODEL: GD1.25

Specification: Green Drain (model: GD1.25) Waterless Trap Seal for 1.25" Drains.
ABS Plastic Housing | One-way Silicone Valve | Silicone Gasket

Function: Installs into the outlet of drain bodies, or drain hubs to protect the trap seal from evaporation. It prevents drain odors, sewer gases, or harmful biological aerosols or pathogens from infiltrating your building. Plus, it also helps to keep pests out. Provides waterless trap seal protection equivalent to water based trap primers.

- **New Construction:** Used as a trap primer replacement or in conjunction with a trap primer to provide protection against escaping sewer gases. Eliminates the need to repair/replace trap primers when they fail.
- **Retrofit:** Used in situations where trap primers have failed or where trap primers were never installed.

Benefits: Simple to install, eliminates the need for complex, time consuming, and expensive repairs. ECO friendly providing 100% water savings efficiency over traditional methods.

Flow Rates: Test Level C – 120 ± 2 mm for waste outlets and traps for basins, bidets, shower trays and kitchen sinks: 7.27 L/M.

Flow Rates: Test Level U – 300 ± 2 mm for waste outlets and traps for baths: 29.22 L/M.

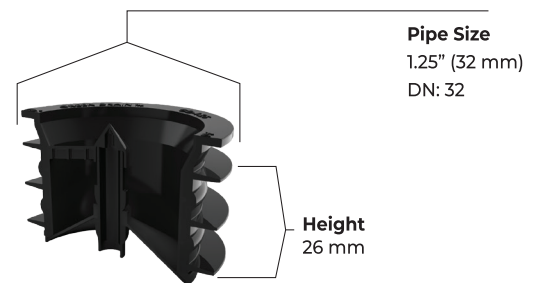
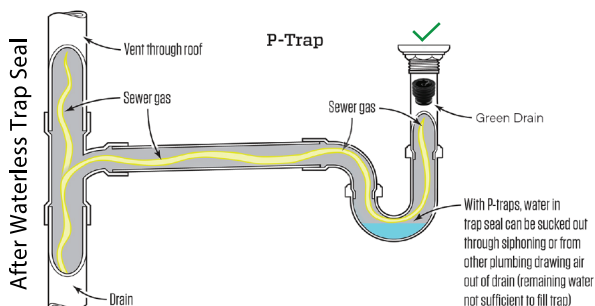
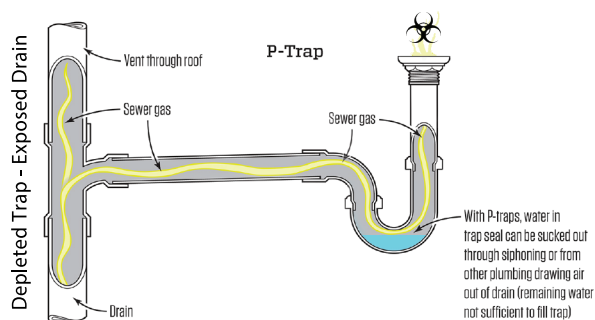

Patent No. 7900288 and 9027172

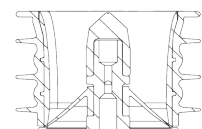
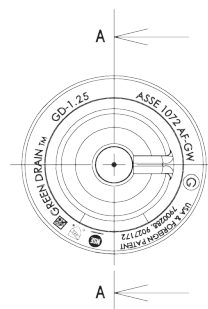
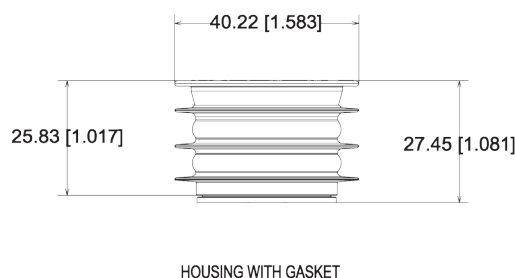
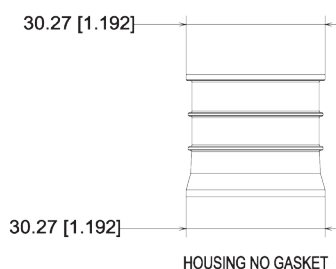

SECTION A-A
2023 Version





1.5" Green Drain™

Waterless Trap Seal for Floor Drains

MODEL: GD15

Specification: Green Drain (model: GD15) Waterless Trap Seal for 1.5" Drains.
ABS Plastic Housing | One-way Silicone Valve | Silicone Gasket

Function: Installs into the outlet of drain bodies, or drain hubs to protect the trap seal from evaporation. It prevents drain odors, sewer gases, or harmful biological aerosols or pathogens from infiltrating your building. Plus, it also helps to keep pests out. Provides waterless trap seal protection equivalent to water based trap primers.

- **New Construction:** Used as a trap primer replacement or in conjunction with a trap primer to provide protection against escaping sewer gases. Eliminates the need to repair/replace trap primers when they fail.
- **Retrofit:** Used in situations where trap primers have failed or where trap primers were never installed.

Benefits: Simple to install, eliminates the need for complex, time consuming, and expensive repairs. ECO friendly providing 100% water savings efficiency over traditional methods.

Flow Rates: Test Level C – 120 ± 2 mm for waste outlets and traps for basins, bidets, shower trays and kitchen sinks: 24.21 L/M.

Flow Rates: Test Level U – 300 ± 2 mm for waste outlets and traps for baths: 51.55 L/M.

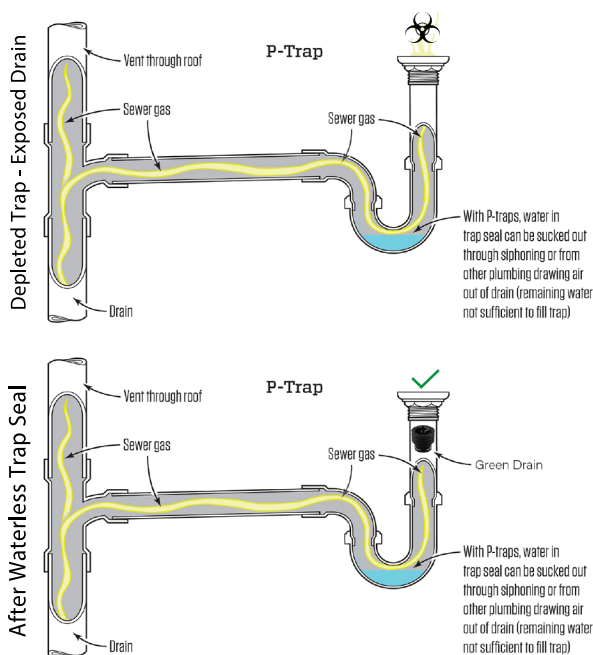

Patent No. 7900288 and 9027172

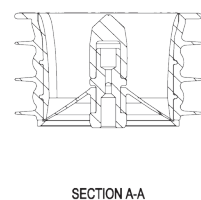
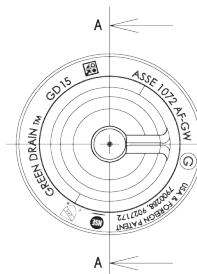
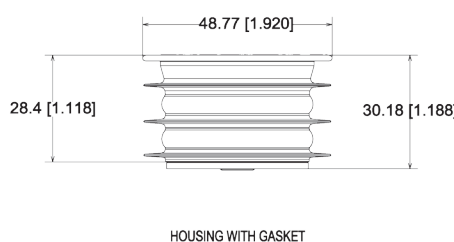
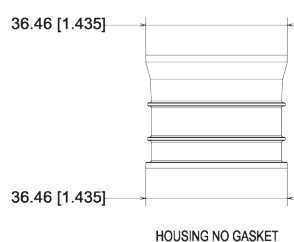



2" Green Drain™

Waterless Trap Seal for Floor Drains

MODEL: GD2

Specification: Green Drain (model: GD2) Waterless Trap Seal for 2" Drains.
ABS Plastic Housing | One-way Silicone Valve | Silicone Gasket

Function: Installs into the outlet of drain bodies, or drain hubs to protect the trap seal from evaporation. It prevents drain odors, sewer gases, or harmful biological aerosols or pathogens from infiltrating your building. Plus, it also helps to keep pests out. Provides waterless trap seal protection equivalent to water based trap primers.

- **New Construction:** Used as a trap primer replacement or in conjunction with a trap primer to provide protection against escaping sewer gases. Eliminates the need to repair/replace trap primers when they fail.
- **Retrofit:** Used in situations where trap primers have failed or where trap primers were never installed.

Benefits: Simple to install, eliminates the need for complex, time consuming, and expensive repairs. ECO friendly providing 100% water savings efficiency over traditional methods.

Flow Rates: Test Level C – 120 ± 2 mm for waste outlets and traps for basins, bidets, shower trays and kitchen sinks: 35.25 L/M.

Flow Rates: Test Level U – 300 ± 2 mm for waste outlets and traps for baths: 82.50 L/M.

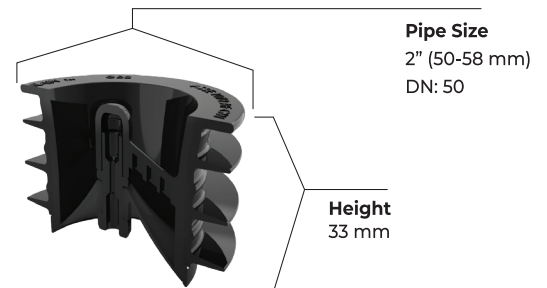
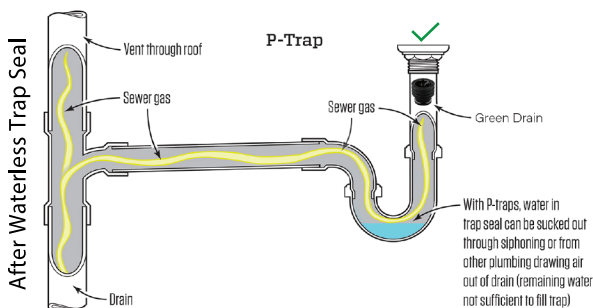
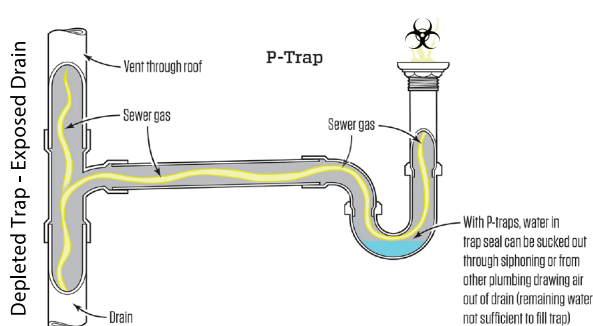

Patent No. 7900288 and 9027172

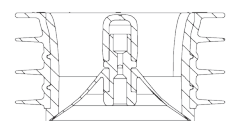
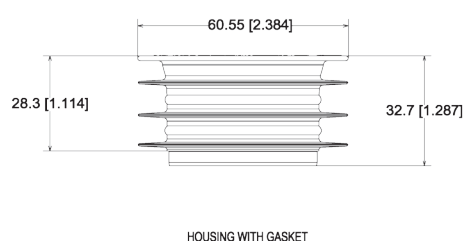

SECTION A-A





2.5" Green Drain™

Waterless Trap Seal for Floor Drains

MODEL: GD25

Specification: Green Drain (model: GD25) Waterless Trap Seal for 2.5" Drains.
ABS Plastic Housing | One-way Silicone Valve | Silicone Gasket

Function: Installs into the outlet of drain bodies, or drain hubs to protect the trap seal from evaporation. It prevents drain odors, sewer gases, or harmful biological aerosols or pathogens from infiltrating your building. Plus, it also helps to keep pests out. Provides waterless trap seal protection equivalent to water based trap primers.

- **New Construction:** Used as a trap primer replacement or in conjunction with a trap primer to provide protection against escaping sewer gases. Eliminates the need to repair/replace trap primers when they fail.
- **Retrofit:** Used in situations where trap primers have failed or where trap primers were never installed.

Benefits: Simple to install, eliminates the need for complex, time consuming, and expensive repairs. ECO friendly providing 100% water savings efficiency over traditional methods.

Flow Rates: Test Level C – 120 ± 2 mm for waste outlets and traps for basins, bidets, shower trays and kitchen sinks: 33.8 L/M.

Flow Rates: Test Level U – 300 ± 2 mm for waste outlets and traps for baths: 72.50 L/M.

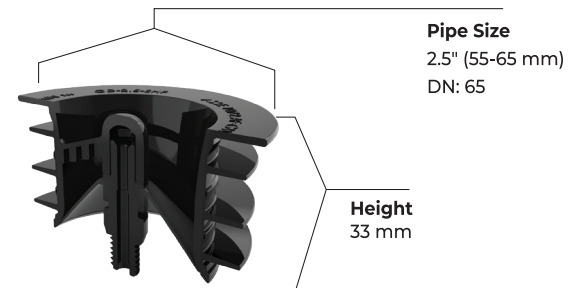
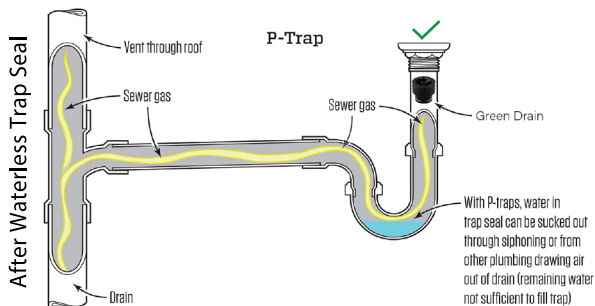
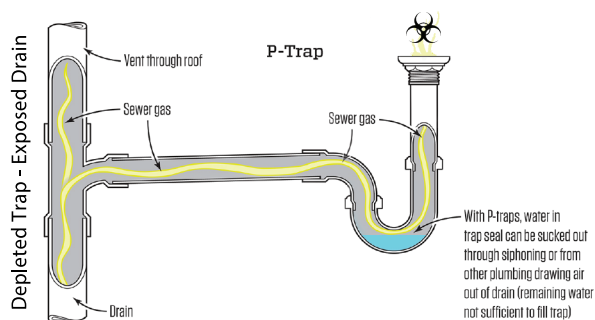

Patent No. 7900288 and 9027172

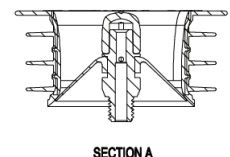
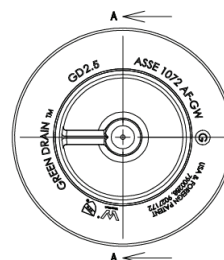
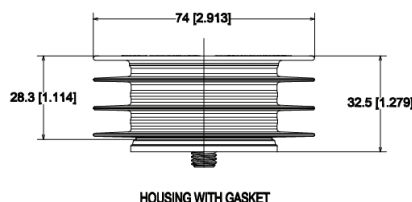



3" Green Drain™

Waterless Trap Seal for Floor Drains

MODEL: GD3

Specification: Green Drain (model: GD3) Waterless Trap Seal for 3" Drains.
ABS Plastic Housing | One-way Silicone Valve | Silicone Gasket

Function: Installs into the outlet of drain bodies, or drain hubs to protect the trap seal from evaporation. It prevents drain odors, sewer gases, or harmful biological aerosols or pathogens from infiltrating your building. Plus, it also helps to keep pests out. Provides waterless trap seal protection equivalent to water based trap primers.

- **New Construction:** Used as a trap primer replacement or in conjunction with a trap primer to provide protection against escaping sewer gases. Eliminates the need to repair/replace trap primers when they fail.
- **Retrofit:** Used in situations where trap primers have failed or where trap primers were never installed.

Benefits: Simple to install, eliminates the need for complex, time consuming, and expensive repairs. ECO friendly providing 100% water savings efficiency over traditional methods.

Flow Rates: Test Level C – 120 ± 2 mm for waste outlets and traps for basins, bidets, shower trays and kitchen sinks: 40.65 L/M.

Flow Rates: Test Level U – 300 ± 2 mm for waste outlets and traps for baths: 105.70 L/M.

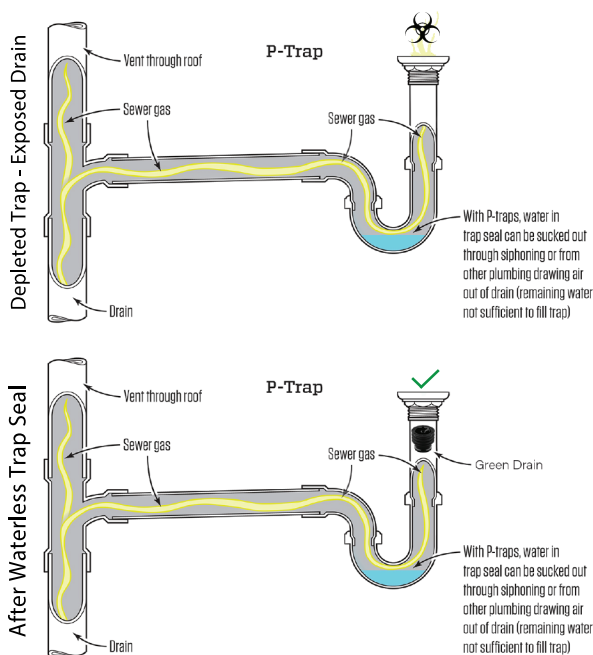

Patent No. 7900288 and 9027172

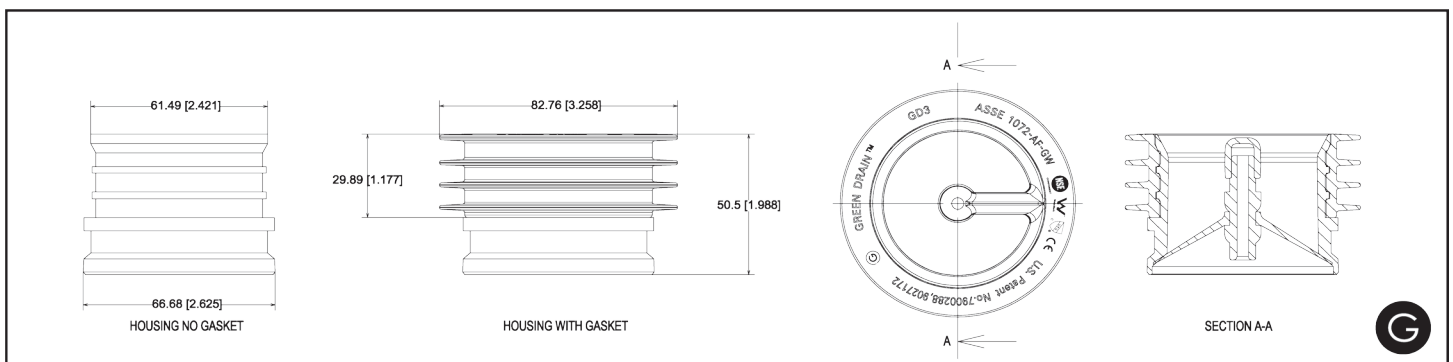



3.5" Green Drain™

Waterless Trap Seal for Floor Drains

MODEL: GD35

Specification: Green Drain (model: GD35) Waterless Trap Seal for 3.5" Drains.
ABS Plastic Housing | One-way Silicone Valve | Silicone Gasket

Function: Installs into the outlet of drain bodies, or drain hubs to protect the trap seal from evaporation. It prevents drain odors, sewer gases, or harmful biological aerosols or pathogens from infiltrating your building. Plus, it also helps to keep pests out. Provides waterless trap seal protection equivalent to water based trap primers.

- **New Construction:** Used as a trap primer replacement or in conjunction with a trap primer to provide protection against escaping sewer gases. Eliminates the need to repair/replace trap primers when they fail.
- **Retrofit:** Used in situations where trap primers have failed or where trap primers were never installed.

Benefits: Simple to install, eliminates the need for complex, time consuming, and expensive repairs. ECO friendly providing 100% water savings efficiency over traditional methods.

Flow Rates: Test Level C – 120 ± 2 mm for waste outlets and traps for basins, bidets, shower trays and kitchen sinks: 121.60 L/M.

Flow Rates: Test Level U – 300 ± 2 mm for waste outlets and traps for baths: 323.17 L/M.

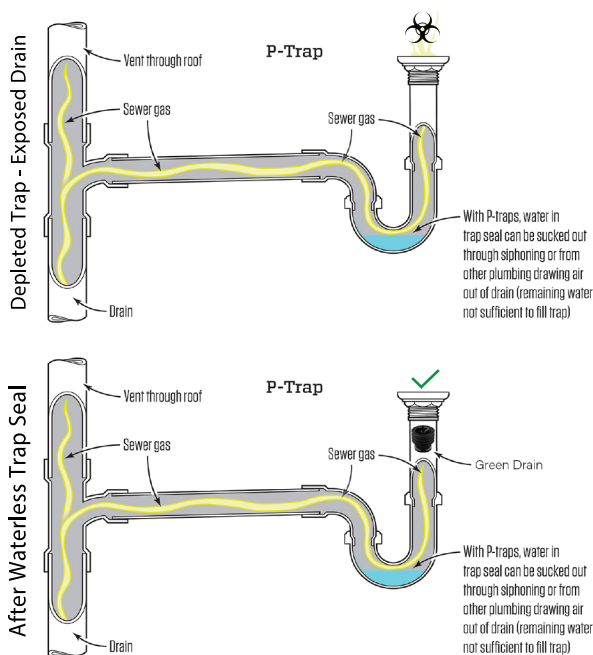

Patent No. 7900288 and 9027172

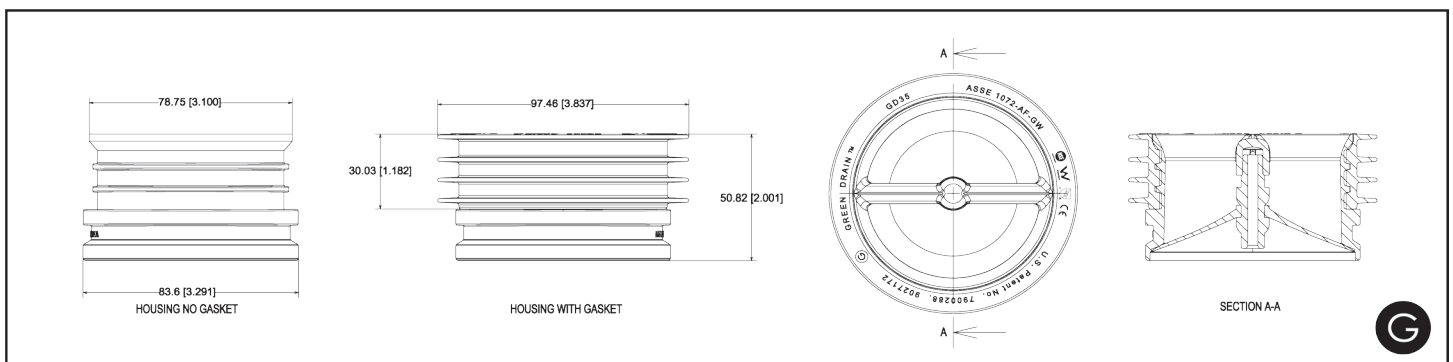



3-3.5 EG Green Drain™

Waterless Trap Seal for Floor Drains

Model: GD3-3.5 EG

Specification: Green Drain (model: GD3-3.5 EG) Waterless Trap Seal for GD3-3.5 EG Drains.
ABS Plastic Housing | One-way Silicone Valve | Silicone Gasket

Function: Installs into the outlet of drain bodies, or drain hubs to protect the trap seal from evaporation. It prevents drain odors, sewer gases, or harmful biological aerosols or pathogens from infiltrating your building. Plus, it also helps to keep pests out. Provides waterless trap seal protection equivalent to water based trap primers.

- **New Construction:** Used as a trap primer replacement or in conjunction with a trap primer to provide protection against escaping sewer gases. Eliminates the need to repair/replace trap primers when they fail.
- **Retrofit:** Used in situations where trap primers have failed or where trap primers were never installed.

Benefits: Simple to install, eliminates the need for complex, time consuming, and expensive repairs. ECO friendly providing 100% water savings efficiency over traditional methods.

Flow Rates: Test Level C – 120 ± 2 mm for waste outlets and traps for basins, bidets, shower trays and kitchen sinks: 40.65 LPM.

Flow Rates: Test Level U – 300 ± 2 mm for waste outlets and traps for baths: 105.70 LPM.

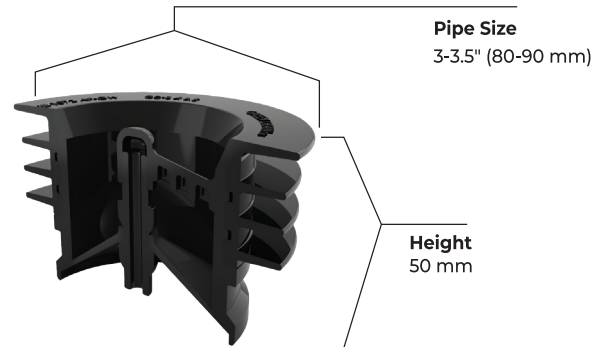
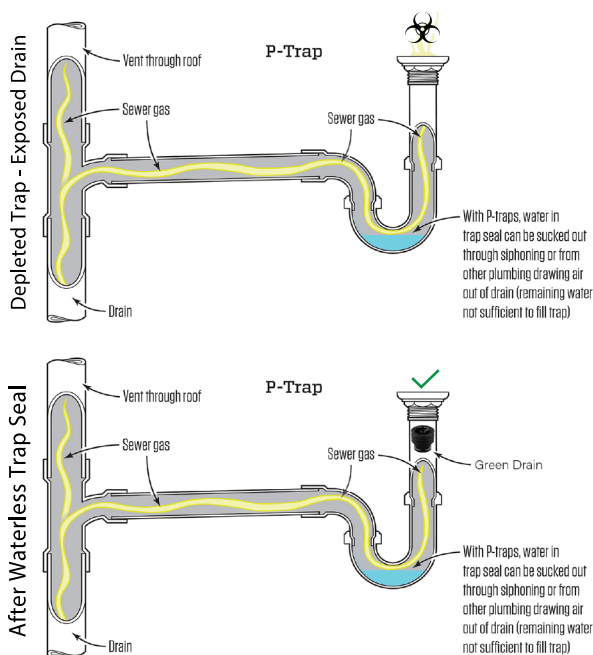

Patent No. 7900288 and 9027172

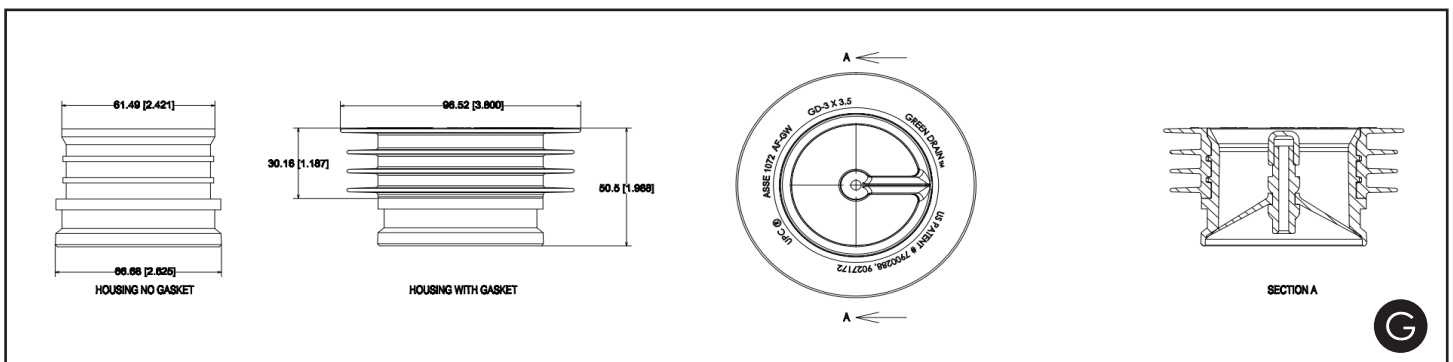

GD35-4 EG Green Drain™

Waterless Trap Seal for Floor Drains

Model: GD35-4 EG

Specification: Green Drain (model: GD35-4 EG) Waterless Trap Seal for GD35-4 EG Drains.
ABS Plastic Housing | One-way Silicone Valve | Silicone Gasket

Function: Installs into the outlet of drain bodies, or drain hubs to protect the trap seal from evaporation. It prevents drain odors, sewer gases, or harmful biological aerosols or pathogens from infiltrating your building. Plus, it also helps to keep pests out. Provides waterless trap seal protection equivalent to water based trap primers.

- **New Construction:** Used as a trap primer replacement or in conjunction with a trap primer to provide protection against escaping sewer gases. Eliminates the need to repair/replace trap primers when they fail.
- **Retrofit:** Used in situations where trap primers have failed or where trap primers were never installed.

Benefits: Simple to install, eliminates the need for complex, time consuming, and expensive repairs. ECO friendly providing 100% water savings efficiency over traditional methods.

Flow Rates: Test Level C – 120 ± 2 mm for waste outlets and traps for basins, bidets, shower trays and kitchen sinks: 121.60 LPM.

Flow Rates: Test Level U – 300 ± 2 mm for waste outlets and traps for baths: 323.17 LPM.

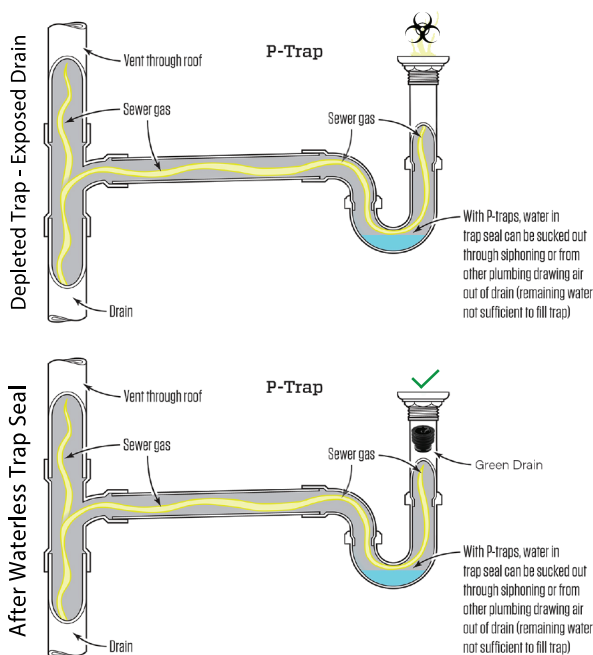

Patent No. 7900288 and 9027172

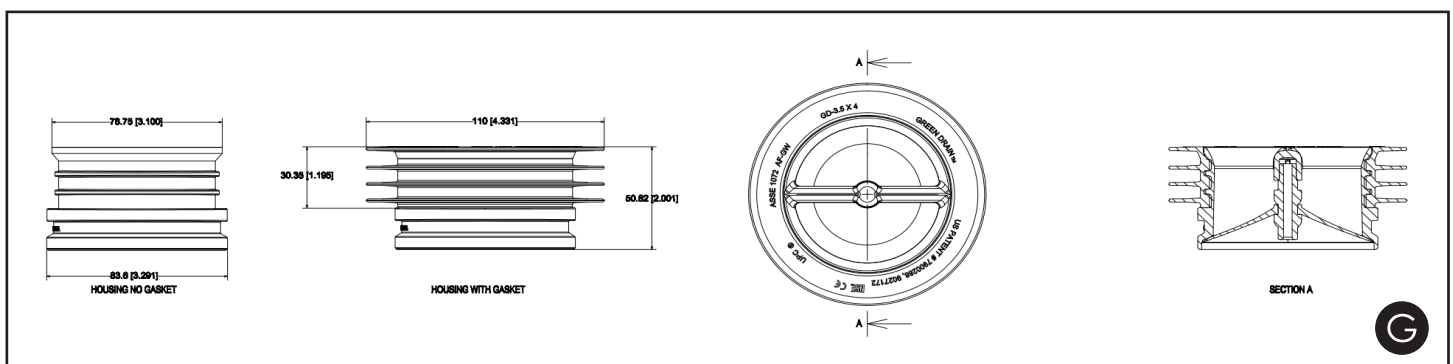

4" Green Drain™

Waterless Trap Seal for Floor Drains

MODEL: GD4

Specification: Green Drain (model: GD4) Waterless Trap Seal for 4" Drains.

ABS Plastic Housing | One-way Silicone Valve | Silicone Gasket

Function: Installs into the outlet of drain bodies, or drain hubs to protect the trap seal from evaporation. It prevents drain odors, sewer gases, or harmful biological aerosols or pathogens from infiltrating your building. Plus, it also helps to keep pests out. Provides waterless trap seal protection equivalent to water based trap primers.

- **New Construction:** Used as a trap primer replacement or in conjunction with a trap primer to provide protection against escaping sewer gases. Eliminates the need to repair/replace trap primers when they fail.
- **Retrofit:** Used in situations where trap primers have failed or where trap primers were never installed.

Benefits: Simple to install, eliminates the need for complex, time consuming, and expensive repairs. ECO friendly providing 100% water savings efficiency over traditional methods.

Flow Rates: Test Level C – 120 ± 2 mm for waste outlets and traps for basins, bidets, shower trays and kitchen sinks: 218.25 L/M.

Flow Rates: Test Level U – 300 ± 2 mm for waste outlets and traps for baths: ≥ 340.00 L/M.

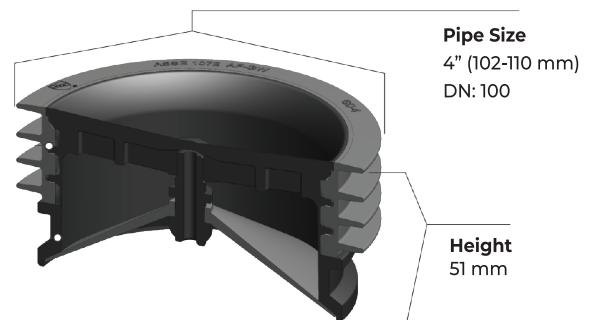
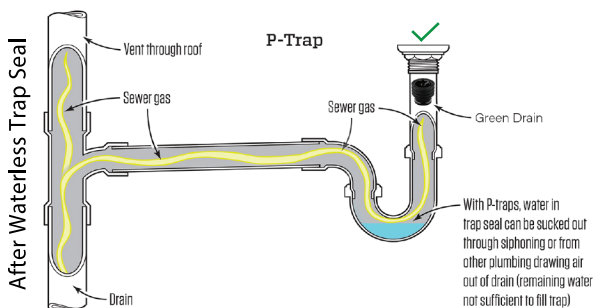
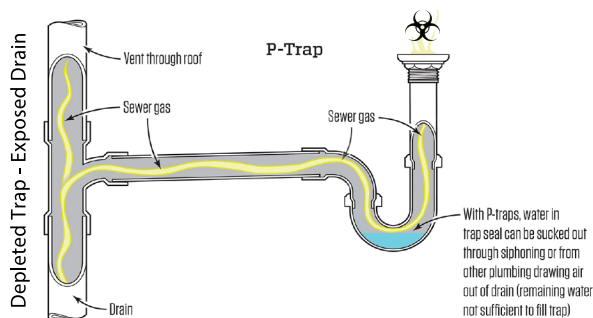

Patent No. 7900288 and 9027172

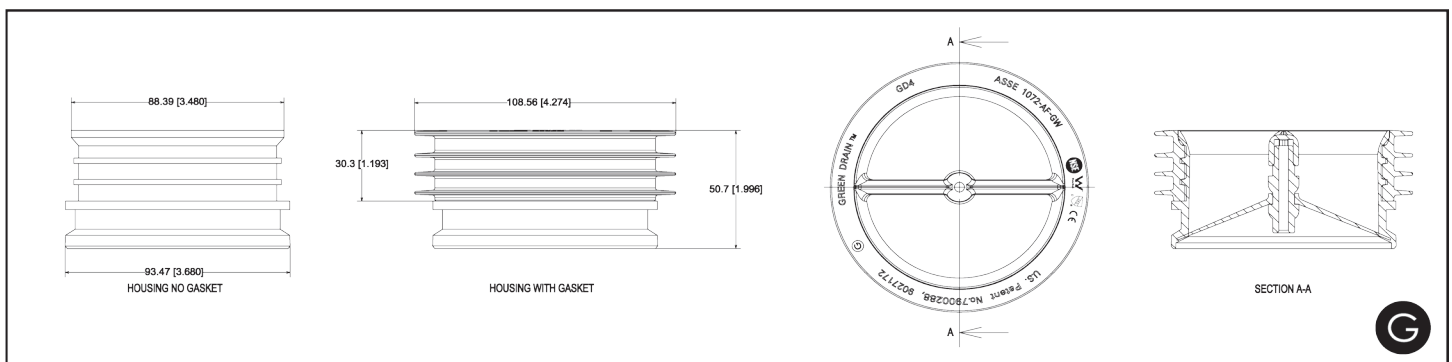



5" Green Drain™

Waterless Trap Seal for Floor Drains

MODEL: GD5

Specification: Green Drain (model: GD5) Waterless Trap Seal for 5" Drains.
ABS Plastic Housing | One-way Silicone Valve | Silicone Gasket

Function: Installs into the outlet of drain bodies, or drain hubs to protect the trap seal from evaporation. It prevents drain odors, sewer gases, or harmful biological aerosols or pathogens from infiltrating your building. Plus, it also helps to keep pests out. Provides waterless trap seal protection equivalent to water based trap primers.

- **New Construction:** Used as a trap primer replacement or in conjunction with a trap primer to provide protection against escaping sewer gases. Eliminates the need to repair/replace trap primers when they fail.
- **Retrofit:** Used in situations where trap primers have failed or where trap primers were never installed.

Benefits: Simple to install, eliminates the need for complex, time consuming, and expensive repairs. ECO friendly providing 100% water savings efficiency over traditional methods.

Flow Rates: Test Level C – 120 ± 2 mm for waste outlets and traps for basins, bidets, shower trays and kitchen sinks: 270 L/M.

Flow Rates: Test Level U – 300 ± 2 mm for waste outlets and traps for baths: 391 L/M.

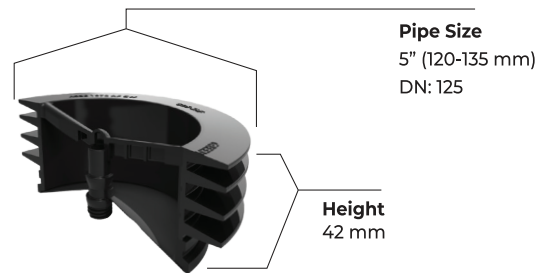
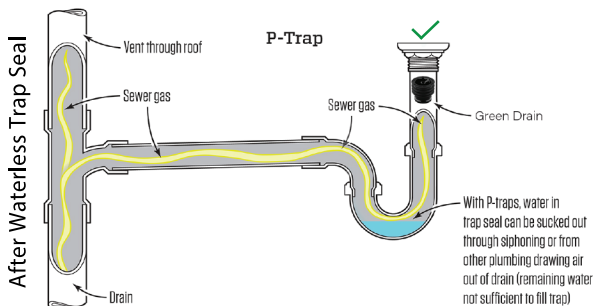
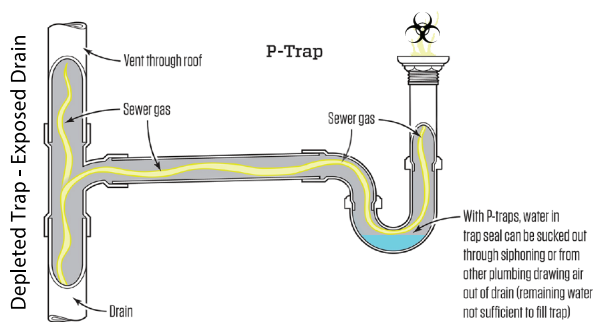

Patent No. 7900288 and 9027172

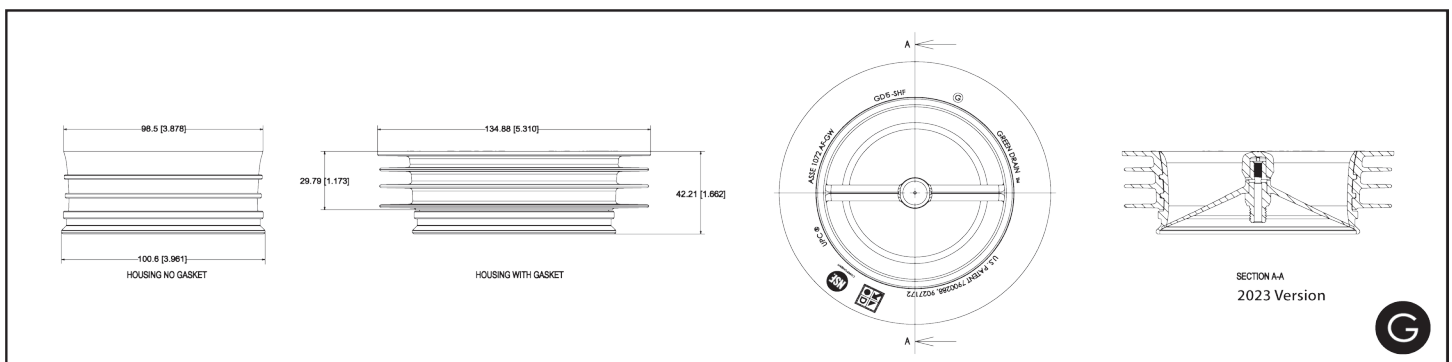



6" Green Drain™

Waterless Trap Seal for Floor Drains

MODEL: GD6

Specification: Green Drain (model: GD5) Waterless Trap Seal for 6" Drains.
ABS Plastic Housing | One-way Silicone Valve | Silicone Gasket

Function: Installs into the outlet of drain bodies, or drain hubs to protect the trap seal from evaporation. It prevents drain odors, sewer gases, or harmful biological aerosols or pathogens from infiltrating your building. Plus, it also helps to keep pests out. Provides waterless trap seal protection equivalent to water based trap primers.

- **New Construction:** Used as a trap primer replacement or in conjunction with a trap primer to provide protection against escaping sewer gases. Eliminates the need to repair/replace trap primers when they fail.
- **Retrofit:** Used in situations where trap primers have failed or where trap primers were never installed.

Benefits: Simple to install, eliminates the need for complex, time consuming, and expensive repairs. ECO friendly providing 100% water savings efficiency over traditional methods.

Flow Rates: Test Level C – 120 ± 2 mm for waste outlets and traps for basins, bidets, shower trays and kitchen sinks: 535 L/M.

Flow Rates: Test Level U – 300 ± 2 mm for waste outlets and traps for baths: ≥550.

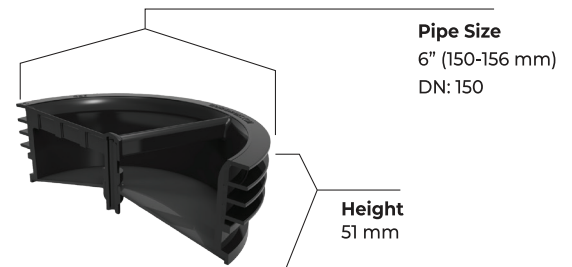
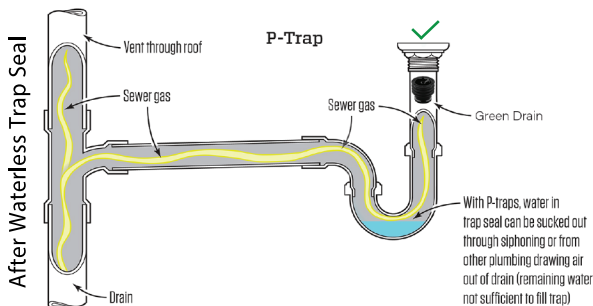
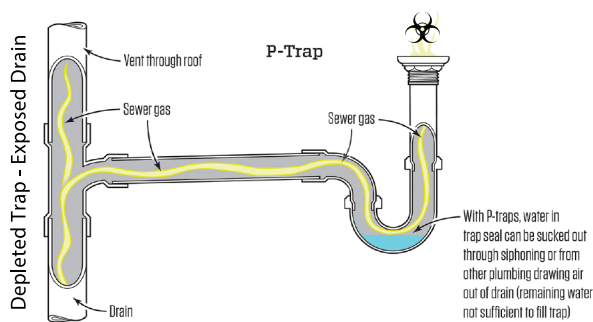

Patent No. 7900288 and 9027172

